



**SW** YESSOR<sup>®</sup>  
WIPES

**LINTEC**  
garments



# CLEANROOM GARMENTS

PRODUCT CATALOGUE

• • • •

# FABRIC SELECTION

| FABRIC TYPE | AUTO | ELECTRONICS | PHARMA | PRINT | FOOD |
|-------------|------|-------------|--------|-------|------|
| ESD         | ✓    | ✓           | ✓      | —     | —    |
| LINT FREE   | —    | —           | ✓      | ✓     | ✓    |
| KNITTED     | —    | —           | ✓      | —     | ✓    |

## AVAILABLE COLORS AND FABRICS

ESD Garment Fabric - 98% Polyester 2% Carbon  
GSM - 110, Cut: Laser/Knife

Woven Garment Fabric  
100% Polyester GSM - 100

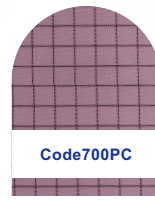
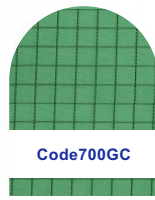
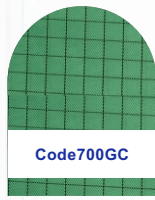

## CHOOSE YOUR GARMENT

COVERALL

LAB COAT



Lintec - Volt EGCA M1



Lintec - Volt EGCA M2



Lintec - Volt EGCA M3



Lintec - Volt EGLC M1



Lintec - Volt EGLC M2

JACKET

HEAD GEAR

SHOE COVER & BOOTIES



Lintec - Volt EGJK M1



Lintec - Volt EGHG M1



Lintec - Volt EGHG M2



Lintec - Volt EGHG M3



Lintec PGSC



Lintec - Volt EGBORS

# PRIMARY GARMENT

OVERALL



PULLOVER



FS - TSHIRT



POLO



TROUSER



Lintec - PGAL

Lintec - PGPO

Lintec - PGLST

Lintec - PGPO

Lintec - PGT

## CUSTOMIZATION

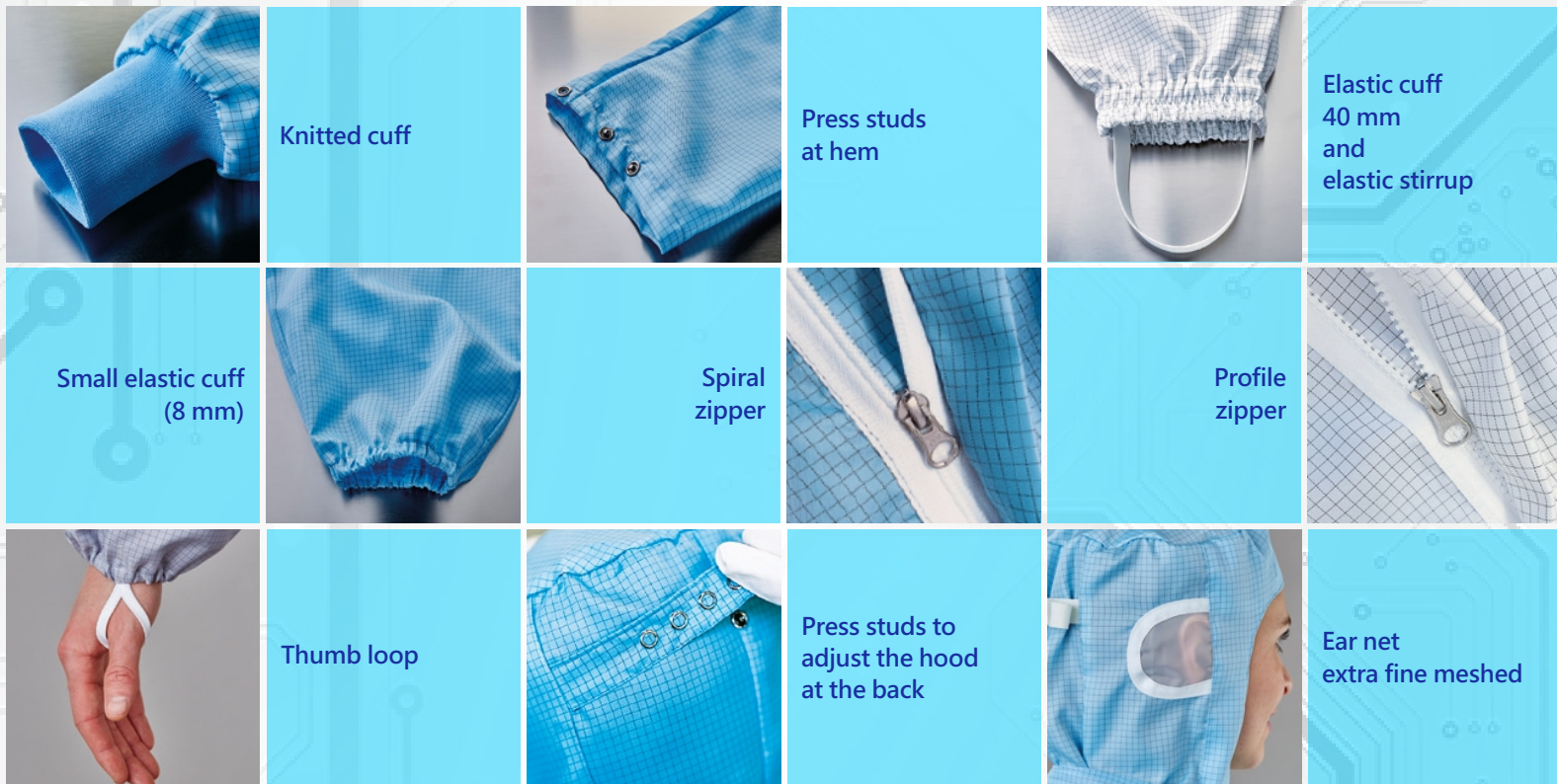

| Garment Type    | Size   | S   | M   | L   | XL  | 2XL | 3XL |
|-----------------|--------|-----|-----|-----|-----|-----|-----|
| Coverall        | Chest  | 112 | 112 | 132 | 142 | 152 | 162 |
| Coverall        | Height | 150 | 153 | 158 | 168 | 173 | 180 |
| Primary Garment | Chest  | 115 | 118 | 120 | 122 | 128 | 130 |
| Primary Garment | Height | 69  | 72  | 74  | 76  | 78  | 60  |
| Trousers        | Waist  | 70  | 72  | 74  | 76  | 78  | 78  |
| Trousers        | Length | 99  | 102 | 105 | 110 | 110 | 114 |
| Lab Coat        | Chest  | 112 | 112 | 132 | 142 | 152 | 162 |
| Lab Coat        | Height | 150 | 153 | 158 | 168 | 173 | 180 |

## SIZE CHART



**FOR MORE INFORMATION PLEASE CONTACT US!**

